

DURACELL[®]

M250 PORTABLE CHARGING HUB

USER MANUAL



INCLUDED IN THE PACKAGE



1. M250 PORTABLE CHARGING HUB



2. 60W M-DOCK CHARGING DOCK + WALL CHARGER

CHARGING YOUR CHARGING HUB

There are two ways to power the unit:

1. M-Dock Charging

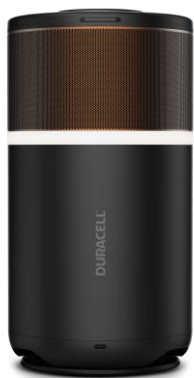

M250 CHARGING ON DOCKING STATION



60W "M DOCK" DOCK STATION WITH WALL CHARGER
Wall Charger Included

2. USB-C Charging



USB-C IN/OUT : 100W PD CHARGING INPUT
USB-C Charger Not Included

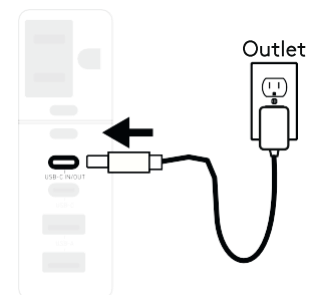
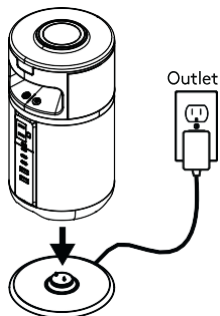

USING YOUR CHARGING HUB

TURNING ON/OFF DEVICE

Turning On Device

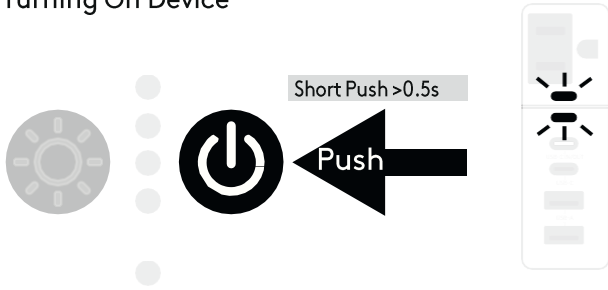

Turning Off Device

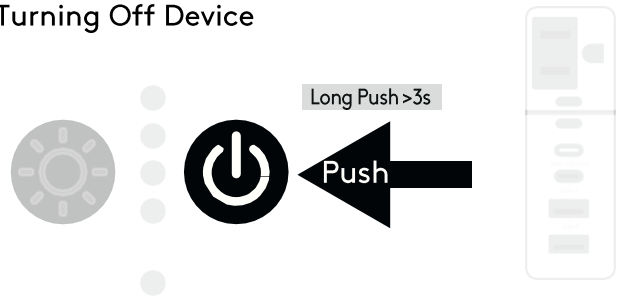

CHARGING DEVICES

USB, AC and Wireless Charging

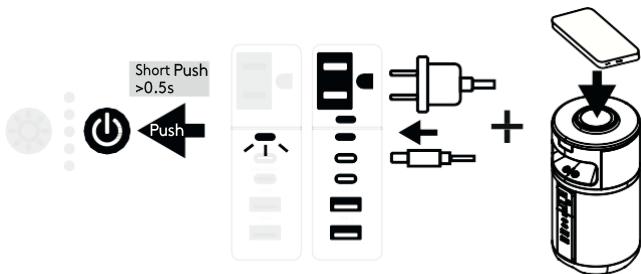

AC outlet will turn off automatically if not in use to preserve power.

Auto Detecting Ports While Charging

(All Ports Will Function While Device Is Being Charged Via USB-C In/Out or M-Dock)

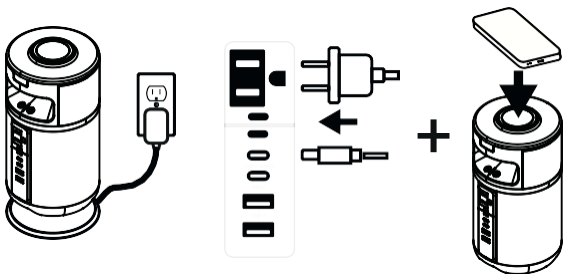

LIGHT RING CONTROL

Turning On Ring Light (power must be on)

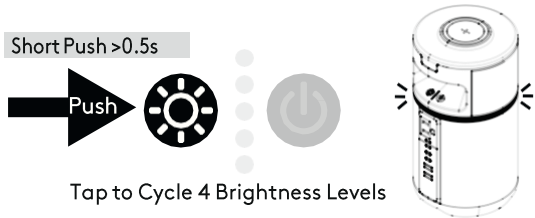

Tap to Cycle 4 Brightness Levels

Turning Off Ring Light

Short Push >0.5s after 5s of no operation



TILTABLE LID

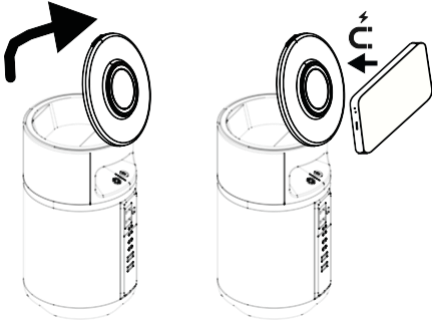

CABLE STORAGE

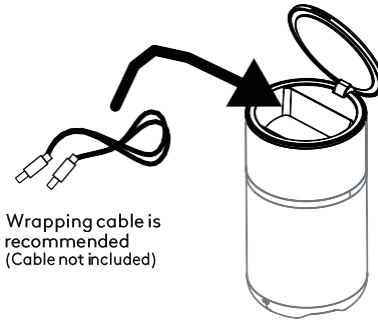

Wrapping cable is recommended
(Cable not included)

BATTERY LEVEL INDICATOR

Battery Level

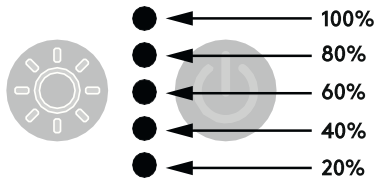

Battery 0%. Must Recharge.

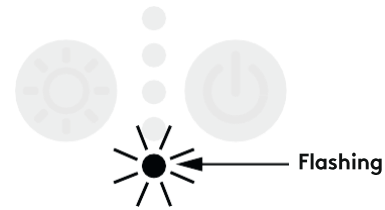

BATTERY LEVEL STATUS LOGIC (5 LED)

Display Battery Level Indicator (%)	Idle State (LED will dim down after 30s)	During Charging	During Discharging
0-20	Bottom LED or LED 1 ON	LED 1- 5 blinking rolling upward from 1 to 5	LED 1 blinking
>20-40	LED 1-2 ON	LED 1 always ON. LED 2- 5 blinking rolling upwards from 2 to 5	LED 1 always ON. LED 2 blinking
>40-60	LED 1-3 ON	LED 1-2 always ON. LED 3- 5 blinking rolling upwards from 3 to 5	LED 1-2 always ON. LED 3 blinking
>60-80	LED 1-4 ON	LED 1-3 always ON. LED 4- 5 blinking rolling upwards from 4 to 5	LED 1-3 always ON. LED 4 blinking
>80-<100	All LED On	LED 1-4 always ON. LED 5 blinking	LED 1-4 always ON. LED 5 blinking
100	All LED On	All LED On	LED 1-4 always ON. LED 5 blinking

STORAGE AND MAINTENANCE

1. Please keep the unit in a cool and well-ventilated environment, away from any source of water, heat, or flammable gases.
2. For long-term storage, please recharge the unit every 3-6 months to make sure it's always above 80% SOC (State of Charge).

DISPOSAL AND RECYCLING

Recycle the Unit responsibly and according to local, state, and national regulations applicable to lithium-ion rechargeable batteries.

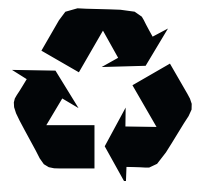

TROUBLESHOOTING

PROBLEM

Unit is not recharging.

SOLUTION

Make sure the M Dock is properly connected to a working AC receptacle. Try another AC receptacle if not working .

Make sure the contacts at the bottom of the unit and at the top of the M-Dock are clean and free from foreign objects.

If M-Dock contacts are damaged, contact Duracell Customer Services.

Make sure the unit is within the operating temperature range. If it is too cold or too hot, it will not charge.

Unit is not charging or powering my device.

Make sure the unit is powered on. If the Battery Level indicator is off, press the power button to turn the M250 on.

If the battery level is too low, the bottom battery level indicator will blink rapidly. In this case, the unit must be recharged before use.

Unit is not charging or powering my devices and the top 4 LEDs blinking.

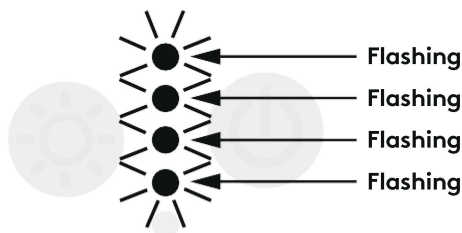

This occurs when the M250 has detected it is outside of its operating temperature range.

If too hot, make sure the fan vents are not obstructed to ensure proper air flow bring the M250 to a cooler location and allow it to return to normal operating temperature.

If too cold, bring the M250 to a warmer location and allow it to return to normal operating temperature.

Bottom LED is blinking.

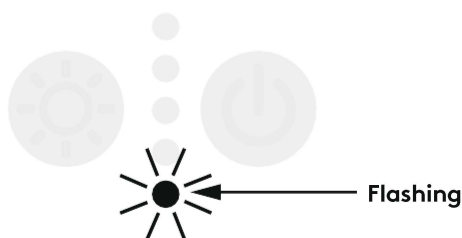

Low battery and battery under voltage shut down: When the battery capacity is low, the bottom LED will blink fast. Place the M250 on the M-Dock and allow it to charge.

I can hear the cooling fan inside the Unit

This is a normal operation of the unit. The fan will automatically turn on and off at variable speeds to maintain the optimal internal temperature.

If you are still experiencing problems with your unit, please visit www.duracell.com or call Duracell Consumer Relations at 800-551-2355.

FREQUENTLY ASKED QUESTIONS



1. What battery does my M250 use?

It uses high-performance lithium-ion cells.

2. What devices can my M250 power?

With a total max of 250W continuous power, the M250 can power a wide range of portable electronic devices and laptops.

3. How long will my M250 keep my devices running?

That will depend on the power consumption of each connected device. The Battery Level indicator will show the remaining state of charge.

4. How to store my M250?

Before storing, make sure to turn off the Unit first and then store it in a dry, well ventilated place at room temperature (42-85°F). Do not place it near water sources. For long-term storage, recharge every 3-6 months to ensure the battery is always above 80% to protect the battery life.

5. Can I recharge my M250 while using it?

Yes, the M250 can be charged and used at the same time, but it will extend the recharge time.

6. Can my M250 be used as an Uninterrupted Power Supply (UPS)?

No, the M250 is not designed to be used as a UPS.

7. Can I bring my M250 on a plane?

Check with the airline.

WARRANTY INFORMATION

Duracell covers a 24-month limited warranty from the date of purchase. Keep a copy of your purchase receipt as proof of purchase. Our product's warranty is limited only to the unit itself when used normally in accordance with the operating instructions and the system environment. The customer acknowledges and agrees that:

- Duracell is not liable for damage or loss resulting from the use of this product or for any claim from a third party.
- Duracell is not liable for problems with any electronic devices or home appliances or any other hardware arising from the use of this product, the suitability of the product for specific hardware, software, or peripherals, operating conflicts with other installed software, data loss, or other accidental or unavoidable damages.
- Duracell is not liable for financial damages, lost products, claims from third parties, etc., arising from the use of this product.

For more information regarding our product line, customer service and warranty information please contact **Duracell Consumer Relations at 800-551-2355** or visit our website: www.duracell.com

IMPORTANT SAFETY INFORMATION



1. Read all the instructions before using the M250.
2. To reduce the risk of injury, close supervision is necessary when the M250 is used near children.
3. Do not expose the M250 to rain or snow or use it when lightning is expected or present. Do not place the unit in direct sunlight. Only place it in clean, dry places.
4. Use only recommended Duracell accessories and chargers.
5. Do not expose the M250 to fire or excessive temperature. Any such exposure to fire or temperature above 140°F (60°C) may cause an explosion. Do not use near flammable gases or fumes.
6. Do not use the M250 with damaged wires or plugs.
7. Do not use the M250 if it is damaged or modified. Damage or modification of the M250, including the lithium-ion battery pack within it, may exhibit unpredictable behavior resulting in fire, explosion, or risk of injury.
8. Make sure to use the M250 in a ventilated environment. Do not restrict the ventilation of the M250 in any way during usage.
9. During storage, keep the M250 in a dry and ventilated place to avoid moisture and electric shock.
10. This M250 has no serviceable parts.
11. Do not disassemble, repair, or modify the M250. It may cause fire, explosion, injury, and unpredictable risks.
12. Do not remove power cables by pulling on the cable itself, as it may fray and cause a short circuit. Cables should be properly removed by holding their connectors and pulling.
13. Do not put coins, metal credit cards, or any other metal objects between your phone and the tiltable lid during wireless charging.
14. Please visit www.duracell.com or call Duracell Consumer Relations at 800-551-2355 if you experience any problems with the M250.

If instructions are not followed, it can cause hospitalization, serious injury, or death. Serious injuries include blindness, burns, electric shock, etc., leading to complications.

WARNING AND HAZARD TYPES



ELECTRIC SHOCK HAZARD

Do not subject the M250 to mechanical shock. Keep away from children.

The M250 generates the same potentially lethal 120V AC Voltage as a standard household wall outlet. To reduce the risk of fire or electric shock, do not open the enclosure or expose the M250 to rain or moisture. Do not insert foreign objects into the AC connection or the ventilation holes. All USB and AC plugs must be appropriately inserted and avoid using damaged cables. Do not operate outside of its operating temperature range.

FIRE HAZARD

Do not burn or incinerate the M250. Exposing the M250 to heat or fire may cause an explosion and personal injury or damage. Do not use near flammable gases or fumes or apparatus that produces large amounts of heat.

APPLIANCE CAUTIONS (for Simulated/Quasi/Modified Sinusoidal AC Waveform):

The M250's AC output is a 100W 120V/60Hz modified sinusoidal wave intended for charging portable electronic devices such as Laptops, Tablets, and Mobile phones.

The AC output can also be used for small fans and lights and charging of other portable electronic devices.

Some fans with synchronous motors may create noise when powered by a modified sinusoidal waveform AC Voltage.

Some devices require a pure sinusoidal wave AC output and can be damaged by a modified sinusoidal wave. Please check the manufacturer's recommendation. Devices rated more than 100W (e.g. Toaster, Coffee Maker, Refrigerator, Hair Dryer, etc.) will not function.

DO NOT plug small appliances into the M250's AC receptacle to directly recharge their nickel-metal hydride batteries.

DO NOT use a modified Sinusoidal Waveform AC voltage with the below two types of equipment or appliances that are susceptible to damage:

- Small, battery- operated appliances such as flashlights, cordless razors, and toothbrushes that can be plugged directly into an AC receptacle to recharge.
- Certain battery chargers for battery packs that are used in some cordless hand tools. Chargers for these tools have a warning label stating that dangerous voltages are present at the battery terminals.

PRODUCT SPECIFICATIONS

Product Name	M250
Model	MBA250W-219Wh-120V
Battery	
Chemistry	Li-Ion NMC
Battery Pack Nominal Voltage/Capacity	14.6V/ 15Ah
Battery Pack Nominal Energy	219Wh
Lifecycles	500 Cycles to 80% capacity
Storage Requirement	Recharge every 3-6 months
Battery Pack Protections	Short Circuit Protection, Over / Under Temperature Protection, Overload Protection, Battery Under and Overvoltage Protection
Ports	
AC Port	1 x 100W, Single phase, 120Vac 60 Hz (Quasi sine wave/Simulated sine wave)
USB-C IN/OUT Port (Input and Output)	1 x 5V-3A / 9V-3A / 15V-3A / 20V-3A /20V-5A (100W Max)
USB-C Port (Output)	1 x 5V-3A / 9V-3A / 15V-3A / 20V-3A (60W Max) ***
USB-A Ports (Output)	2 x 5V-3A / 9V-3A / 12V-3A / 20V-3A (60W Max)***
Tilt Top Wireless Charger (Output Port)	15W max
360° Ring Light	2W @ 3000K CCT
Docking Station/Charging Dock	Compatible with M Dock
DC Total Output	(1)177W (Nominal, C1 100W+C2 60W+Qi 15W+Lighting 2W) when AC output is OFF. (2)150W (Nominal, C1 100W+C2 33W+Qi 15W+Lighting 2W) when AC output is ON.
AC & DC Total Output Max	250W (Nominal). (AC 100W+USB C-1100W+USB C-2 33W+Qi 15W+Lighting 2W).
General	
Dimensions	M250: Ø127.4x236.4mm M-Dock: Ø110x14mm (excluding adapt or)
Weight	M250: 2050g±20g Adaptor & Dock: 330g±10g
PPS M250 Protections	Short Circuit Protection, Over / Under Temperature Protection, Overload Protection, Battery Pack Over Voltage Protection & Under Voltage Protection
Discharging Temperature	3.2 -104°F (-16-40°C)
Charging Temperature	39.2-104°F (4-40°C)
Storage Temperature	42-85°F (6-29°C)
Certifications	FCC/DOE/UL/RoHS/Prop-65/TSCA

Warranty

24 Months

*** The USB-C output port and the two USB-A output ports share the same 60W Max output circuit. Refer to the table below for multiple output power combinations and limits.

SIMULTANEOUS MULTI-PORT COMBINATION & OUTPUT POWER LIMITS

No.	Load condition	AC	USB-C In/Out	USB-C	USB-A 1	USB-A 2	Wireless Charger	Ring Light	Total Power	
1	Each port works independently	100W	x	x	x	x	x	x	100W	
		x	100W	x	x	x	x	x	100W	
		x	x	60W	x	x	x	x	60W	
		x	x	x	60W	x	x	x	60W	
		x	x	x	x	60W	x	x	60W	
		x	x	x	x	x	15W	x	15W	
		x	x	x	x	x	x	2W	2W	
2	Total Max power combination	100W	100W	33W	x	x	15W	2W	250W	
		100W	100W	x	33W	x	15W	2W	250W	
		100W	100W	x	x	33W	15W	2W	250W	
	Multi-device combination	100W	100W	When two or more devices are plugged in at the same time, share 5V/3.6A 18W				15W	2W	235W
		x	100W	60W	x	x	15W	2W	177W	
		x	100W	x	60W	x	15W	2W	177W	
		x	100W	x	x	60W	15W	2W	177W	
		100W	x	60W	x	x	15W	2W	177W	
		100W	x	x	60W	x	15W	2W	177W	
		100W	x	x	x	60W	15W	2W	177W	
3	Under various output combinations, the total output power shall not exceed 250W.									

To enhance the safe operation of the M250, the M250 will automatically reduce the power during high-temperature operation.

FCC STATEMENT



This device complies with Part 15 of the FCC Rules and Class B Digital Device limits which provide protection against interference in a residential installation. Operation is subject to the following two conditions:

1. This device may not cause harmful interference
2. This device must accept any interference received, including interference that may cause undesired operation.

This device generates, uses, and can radiate radio frequency energy and, if not installed and used in accordance with the instructions, may cause interference to radio/TV communications for which the manufacturer is not responsible. Should interference occur, correct by connecting the device to another outlet on a different circuit.

Changes or modifications to this M250 not expressly approved by the party responsible for compliance could void the user's authority to operate the equipment.

NOTE: This equipment has been tested and found to comply with the limits for a Class B digital device, pursuant to Part 15 of the FCC Rules. These limits are designed to provide reasonable protection against harmful interference in a residential installation. This equipment generates uses and can radiate radio frequency energy and, if not installed and used in accordance with the instructions, may cause harmful interference to radio communications.

However, there is no guarantee that interference will not occur in a particular installation. If this equipment does cause harmful interference to radio or television reception, which can be determined by turning the equipment off and on, the user's encouraged to try to correct the interference by one or more of the following measures:

1. Reorient or relocate the receiving antenna.
2. Increase the separation between the equipment and receiver.
3. Connect the equipment to an outlet on a circuit different from that to which the receiver is connected.
4. Consult the dealer or an experienced radio/TV technician for help.

This device contains license-exempt transmitter(s)/receiver(s) that comply with Innovation, Science, and Economic Development Canada's license-exempt RSS(s).

Operation is subject to the following two conditions:

1. This device may not cause interference.
2. This device must accept any interference, including interference that may cause undesired operation of the device.